

P SMALL

P is the optimal system for the automatic washing of medium size mechanical parts.

Washing is carried out by the action of upper, lower and side nozzles.

Basket rotates through a gear motor. The switchboard is electromechanical.

Operators can set the tank liquid temperature as well as the length of the treatment cycle.

The machine is available in LT version (without insulation, maximum and adjustable temperature up to 60°C).

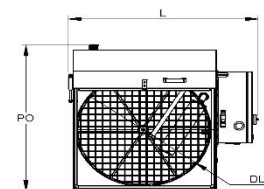
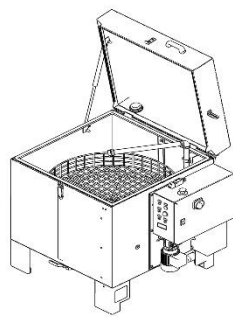
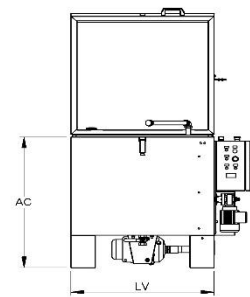
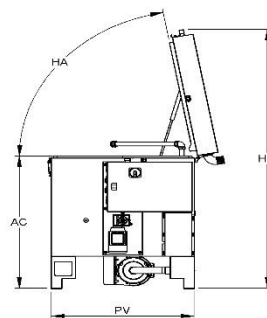

Dimensions and layout	P60	P80
depth with opened machine (PO)	86 cm	105 cm
height with opened machine (HO)	153 cm	185 cm
loading height (AC)	83 cm	92 cm
noise LT (RU)	75 dBA	75 dBA
opening angle (HA)	80°	80°
tank depth (PV)	64 cm	84 cm
tank width (LV)	64 cm	84 cm
washing height (HL)	38 cm	43 cm
weight (W)	85 Kg	96 Kg
width (L)	92 cm	112 cm
working diameter (DL)	58 cm	78 cm

Connections	P60	P80
Cabin vent outlet	Ø50 mm	Ø50 mm
Compressed air blower solenoid valve	F 1"	F 1"
Deoiling oil drain	M 1/2"	M 1/2"
Electrical connection: plug	3P+PE 16A	3P+PE 16A
Emptying pump	F 1"	F 1"
Steam extraction	M 1" 1/2	M 1" 1/2
Tank liquid drain	F 1"	F 1"

Technical data	P60	P80
Compressed air blowing	95 Nmc/h @ 4 bar	105 Nmc/h @ 4 bar
Disk oil separator	0,09 kW	0,09 kW
Heating tank 1	4 kW	4 kW
High pressure pump 1	2,2 kW - 5/6 bar - 150/100 lt/min	2,2 kW - 5/6 bar - 150/100 lt/min
Load capacity	100 kg	100 kg

Technical data	P60	P80
Motor for parts rotation	0,09 kW	0,09 kW
Pump 1	0,55 kW - 2/3 bar - 100/75 lt/min	0,55 kW - 2/3 bar - 100/75 lt/min
Steam exhauster	0,09 kW 70 Nmc/h	0,09 kW 70 Nmc/h
Tank 1 capacity	60 lt	130 lt
Tank emptying pump	0,37 kW	0,37 kW

Technical features	P60	P80
Aisi 304 stainless steel filter in pump intake	★	★
AISI 304L stainless steel washing pipelines with professional stainless steel flat nozzles	★	★
Basket with external edge in AISI 304L stainless steel	★	X
Cover border gasket	★	★
Digital thermostat for temperature regulation	★	★
Door closure assisted with gas springs and fastening hook	★	★
Drain valves for emptying tanks	★	★
Heating of the liquid with stainless steel electric heating element	★	★
Intake and delivery pump hose (easy maintenance)	★	★
Internal and external welding bleaching	★	★
IP55 main electrical box, electromechanical controls	★	★
Manual water filling valve	★	★
Mechanical rotation of basket via gearmotor	★	★
Minimum level switch	★	★
Reinforced basket in electrically welded mesh with external border in galvanized steel	X	★
Safety limit switch on cover opening	★	★
Stainless steel electric pump with special seals	★	★
Structure and sheet metal in contact with liquid in AISI 304L stainless steel	★	★

Accessories	P60	P80	Cod.
Basket in stainless steel AISI 304L instead of the galvanized one	X	✓	CAX
Compact pneumatic oil separator	✓	✓	MD
Compressed air blowing (fixed time 3") [B]	✓	✓	SACTF
Customization for use of detergents with bacteria	✓	✓	BIO
Disc oil separator integrated into basket rotation	✓	✓	DB1_INT
Emptying pump	✓	✓	SV
High pressure washing pump	✓	✓	PP1
Kit for use with abrasive contaminants in the washing liquid	✓	✓	PCA
Machine equipped with wheels for handling [D]	✓	✓	RUO
Manual idle rotation of the basket for loading and unloading the pieces	X	✓	ROT_FM
Panels under the basket with cap filter for collecting chips [A]	✓	✓	PSC
Pressure regulating valve, with pressure gauge	✓	✓	VRPM
Second ramp of washing nozzles [L]	✓	✓	STR
Stainless steel AISI 304L retention tank with drip-catcher [D]	✓	✓	RIT
Stainless steel fittings and valves kit (for parts that are in contact with liquids)	✓	✓	PFC
Steam extraction [A]	✓	✓	ASP
Upper ramp fastened to the cover [E]	✓	✓	RSCO

Legend notes accessories

[B]: it is mandatory to add the panels under the basket (if present in the price list for this model)

[D]: the two accessories are incompatible, they cannot be installed on the same system

[E]: the useful washing height is reduced by 20 mm

[L]: the high pressure pump is required

★ = included in the basic model, ✓ = available on request, X = not available